

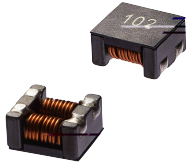

SMD Common Mode Inductor Size 1211



- Chip common mode filter for large current applications.
- Low profile design makes it optimal for surface mounting.
- Operating temperature -40~+125 °C
- Quantity:500 pcs

- Power line noise countermeasure for various electronic equipment
- Noise countermeasure for adapter lines and battery lines or larger electronic equipment such as note PCs and word processors

Dimensions: [mm]

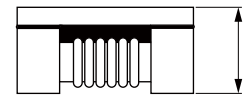
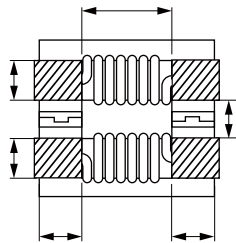
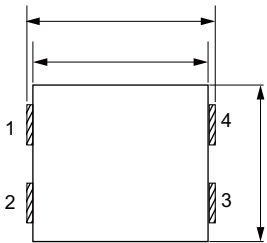

Schematic:

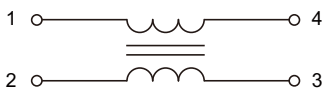

Land Pattern:[mm]

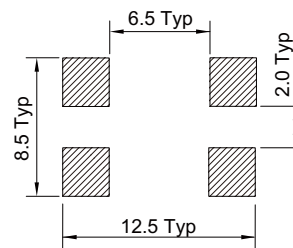

Electrical Properties:

	(Ω)	(Ω)	(mΩ)			(MΩ)



	(Ω)	(Ω)	$(m\Omega)$			$(M\Omega)$

Typical Electrical Characteristics:

