

BCMA Series

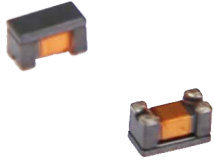

FEATURES

-
-
-
-
-

°C

APPLICATION

-

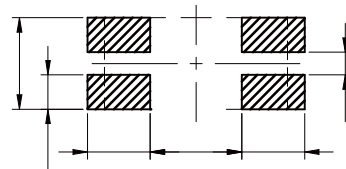
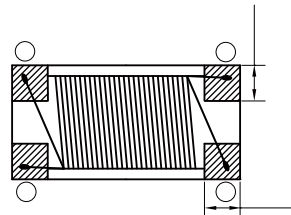
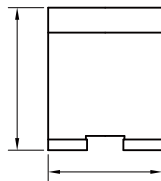
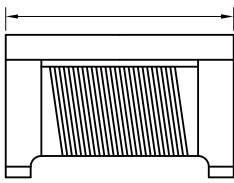

Part No	Impedance @ 100 MHz ()	Tolerance	Temperature Rise Current Max. (mA)	DC Resistance Max. ()	Rated Voltage (V)



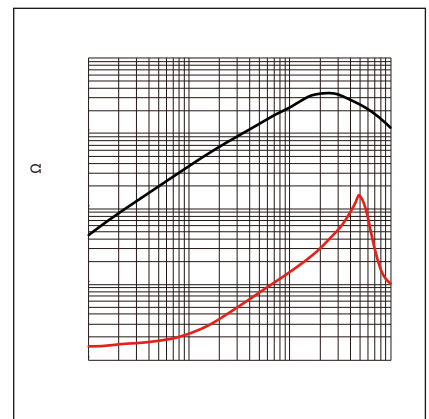
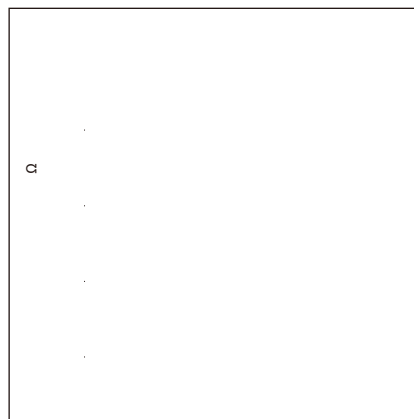
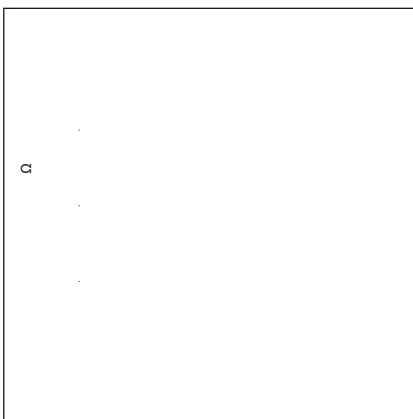
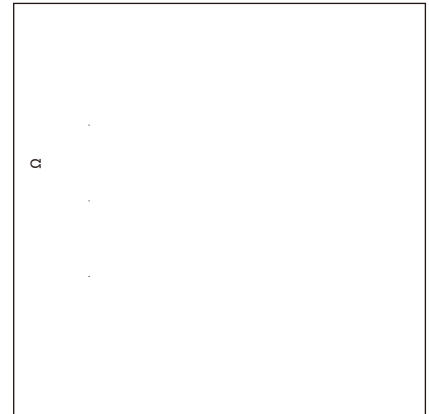
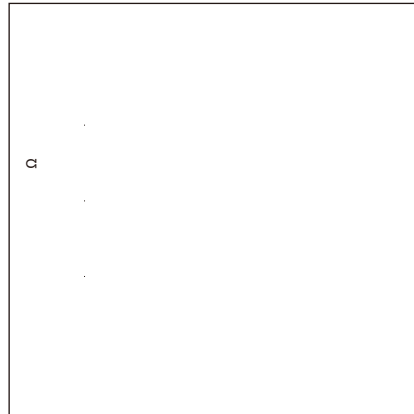
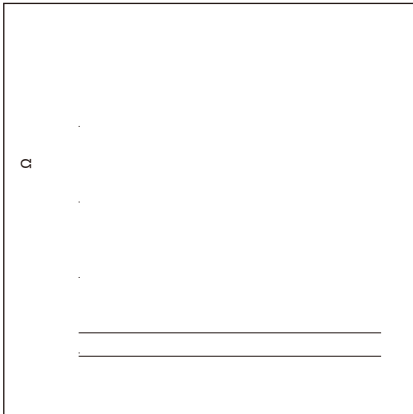

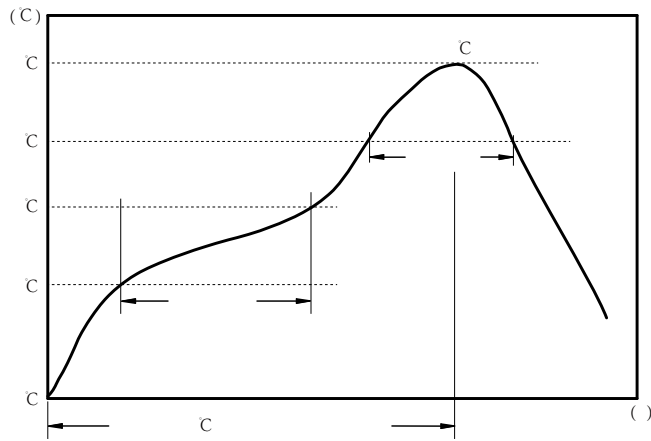

c
c
c

:



BCMA3216	1.88 typ.	3.50 typ.	1.5±0.1	4.0±0.1	4.0±0.1	8.0±0.3	2.1 typ.	1.75±0.1	0.20±0.1
----------	-----------	-----------	---------	---------	---------	---------	----------	----------	----------

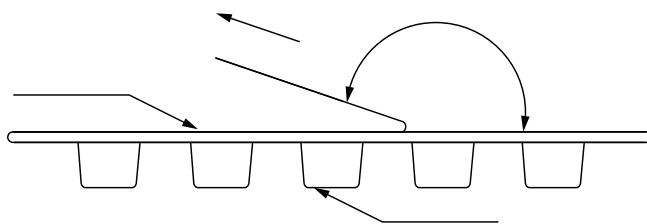

The peel force of top cover tape shall be between 0.1 to 1.0 N

:

